

S5040 4 Channels Standalone NVR



- Supports up to 4 channels
- Linux embedded true standalone NVR
- One click auto installation
- PC-less! Support local configuration, live and playback
- Plug-n-play auto camera installation
- Full HD 1080p 30fps real-time recording for each channel
- Full HD 1080p local display and 30fps real-time decoding for live view and playback
- Smart Streaming Technology for high quality recording and low bandwidth remote viewing
- HDMI and VGA dual video output
- 2-way audio and 8 alarm inputs, 2 alarm outputs
- Easy export via USB or network
- Dual Ethernet ports, isolated local network environment for IP cameras
- CMS up to 16 devices
- Remote access through web browser, CMS software and iOS/ Android apps



Technical Specifications

Standalone NVR	
Model	S5040 4 Channels Standalone NVR
System	
Operating system	Embedded Linux
Operations	Live, recording, playback, backup & remote access
Control mode	USB mouse, webpage, CMS
Video	
Decompression	H.264 HP/ MP/ BP, up to 30 fps in 1920 x 1080
IP camera inputs	4 channels; each one is up to 30 fps in 1920 x 1080
Audio	
Input	1 x RCA
Output	1 x RCA
Audio recording	Yes
Display	
Display mode	Full screen/ multi-screen/ PIP/ sequence
Output	1 x HDMI (1920 x 1080, 60Hz), 1 x VGA (up to 1920 x 1080, 60Hz)
Sequence	Yes
OSD	GUI
Remote view	Yes (via IE Web viewer, CMS)
Mobile viewing on smartphone/ tablet PC	Yes (iOS & Android)
Recording	
Recording mode	Continuous, scheduled, alarm, motion
Recording capability	Up to 120 fps at Full HD (1920 x 1080)
Pre recording	5 seconds
Post recording	Up to 255 seconds
Playback & Backup	
Display mode	Full screen/ multi-screen
Playback capability	4 channels simultaneous playback
Playback control	Play/ pause/ step/ fast forward/ rewind/ fast rewind
Search control	By channel, date/ time, events
Export	Through USB/ webpage/ CMS
Internal storage*	Up to 2 x SATA HDDs
Network	
Support	TCP/IP, SMTP, DHCP, DDNS, PPPoE, UDP, SSL, RTP, RTSP, NTP
Ethernet	1 x 10/ 100 Mbps (WAN), 1 x 10/ 100/ 1000 Mbps (LAN)
I/O	
USB	2 (1 for mouse control and 1 for backup)
Alarm	4 alarm in/ 1 alarm out
RS485	1; support Pelco D, Pelco P
Environmental	
Power supply	Input: AC 100 ~ 240V, 50/ 60 Hz Output: DC 12V/ 5A
Dimension	303 x 59 x 226 mm
Operating conditions	0°C ~ 50°C (32° ~ 122°F) & working humidity 10%RH ~ 90%RH

* SATA HDD not included

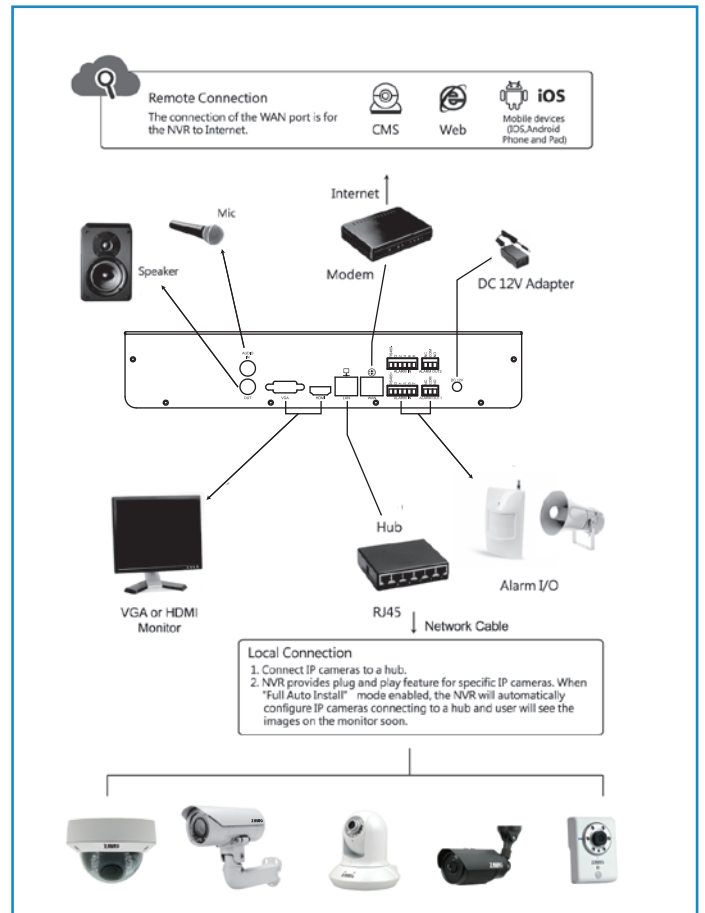

ZAVIO Inc. | 2F., No.13, Yanfa 2nd Rd., East Dist., Hsinchu City 300, Taiwan
 TEL: 886-3-579-0275 | FAX: 886-3-668-6845 | E-Mail: sales@zavio.com